

Case Erector & Sealer Technology



U-PACK YZ - CE & CS SERIES

Automatic Case Erector and Sealer Series

Automatic Case Erector

U-PACK's YZ-CE25 Case Erector is an innovative new case erector for erecting and bottom sealing RSC, HSC and RSC with integral divider cases with tape or hot melt adhesive at speeds of 25 cases per minute. The YZ-CE25 is a combination of U-PACK's proven concepts with new technology, resulting in a machine that offers the highest reliability in its class. The YZ-CE25 features an ergonomically friendly, powered horizontal case magazine. With a vertical case presentation and compact footprint, the YZ-CE25C is ideal for limited floor space applications.

YZ-CE25-T

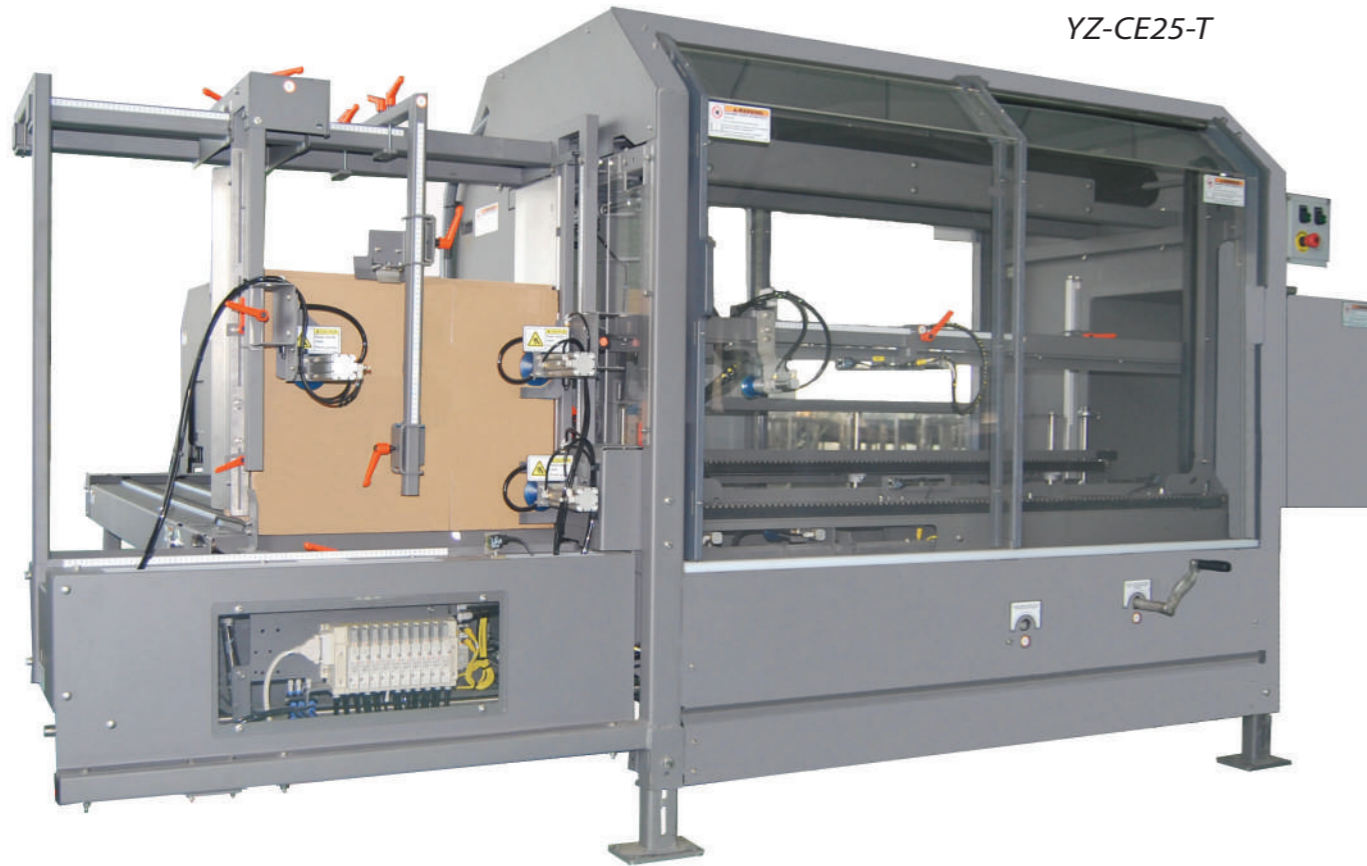

Erected Case size Ranges

Length	Width	Closed Depth	Open Depth
203-610mm	127-406mm	76-470mm	152-533mm

Knocked-down Sizes

Length	Width	Bottom flap width
330-1016mm	203-737mm	63.5-406mm

* Customized according to customer's requirement

Model	Capacity	Sealing type	Weight
YZ-CE25-T	25 CPM	Adhesive tape	3120KG
YZ-CE25-G	25 CPM	Hot melt glue	3480KG

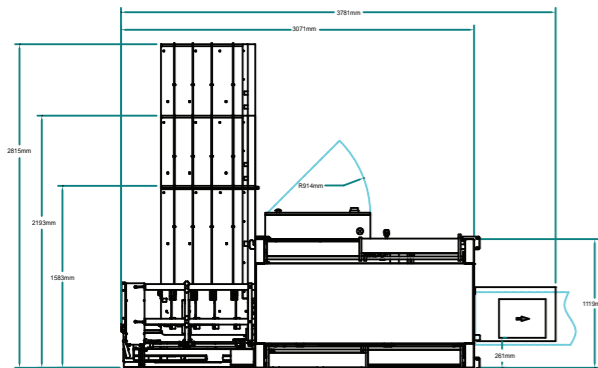

YZ-CE25

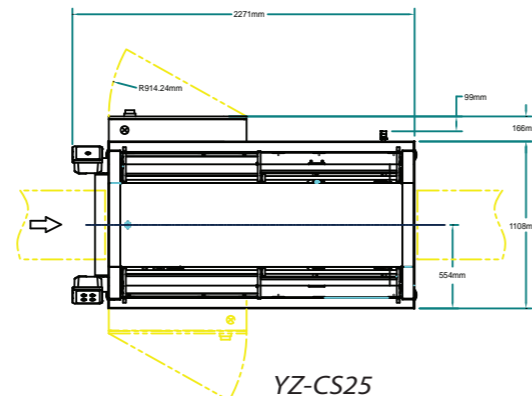
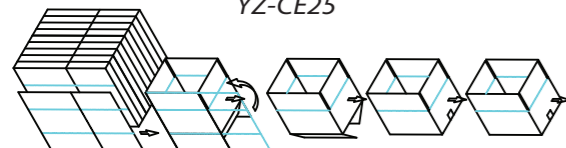

YZ-CS25

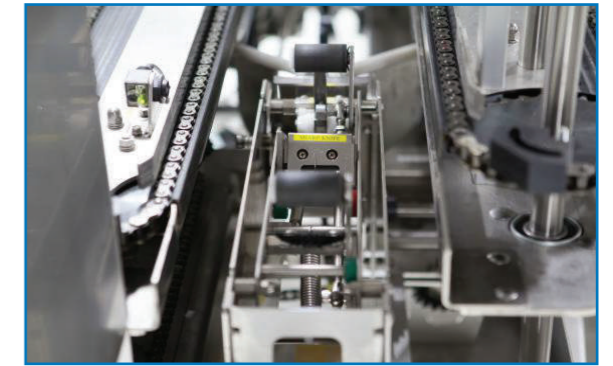

- Integrated Chain Guide System
- Electrically interlocked safety guard package
- Quick 5 minute changeover
- UL Listed Control Panel
- Stainless steel construction optional

The YZ-CE25 mechanically advances cases in the magazine to the pick-off. Once a case is picked, it is advanced into the feed rollers. For case setup, opposing vacuum cups engage the case and erect it. The case is advanced through the machine with U-PACK's Integrated Chain Guide System (patent pending), the bottom flaps are closed using pneumatic actuators and tape or hot melt adhesive is applied. The case is discharged from the machine in the vertical, upright position for easy case filling.

Automatic Case Sealer

YZ-CS25-T

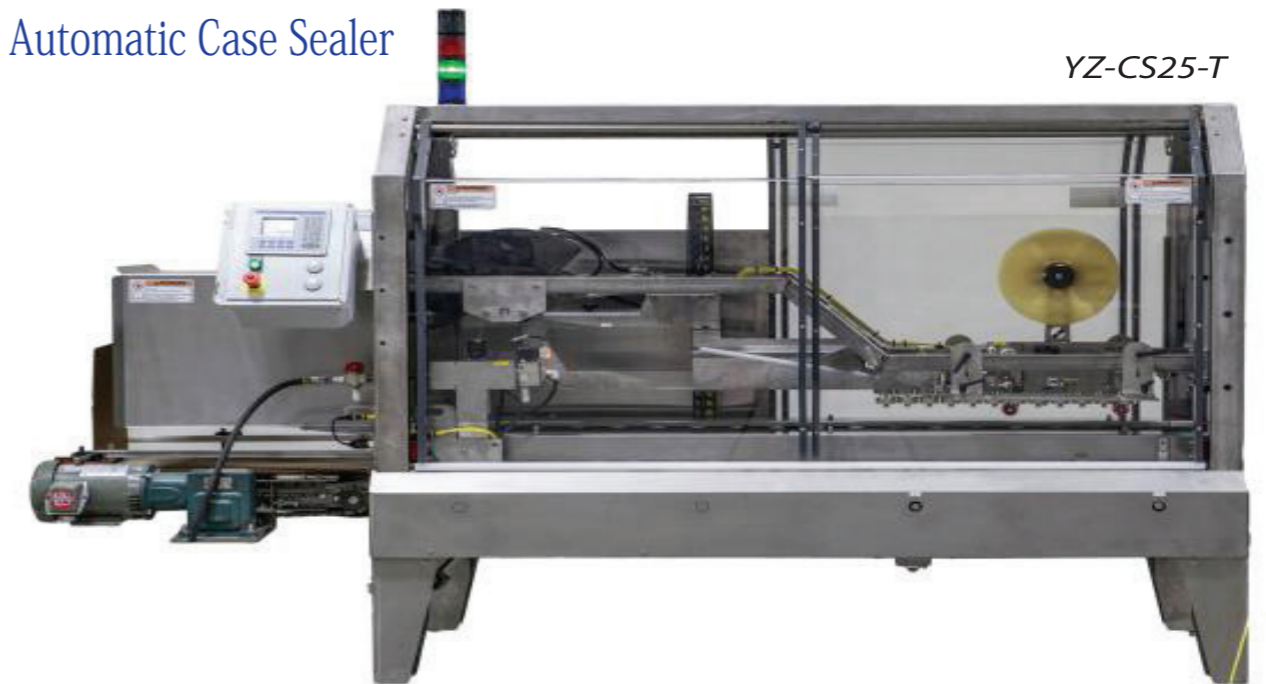

- Rugged, compact, continuous motion case sealer
- 15 cases per minute for the full standard case range with faster speeds possible on shorter case lengths

- No tool quick change over to different case sizes.
- Compensating Independent Roller System for smooth & reliable case transfer through the machine (patented)

- Synchronous Drive System standard
- Allen-Bradley PLC standard
- Pneumatic controlled flap kicker
- Hazard guard package



Sealed Case size Ranges

Length	Width	Height
153-609mm	102-406mm	76-469mm

Model	Capacity	Sealing type	Weight
YZ-CS25-T	25 CPM	Adhesive tape	872KG
YZ-CS25-G	25 CPM	Hot melt glue	908KG

Case Erector & Sealer Technology

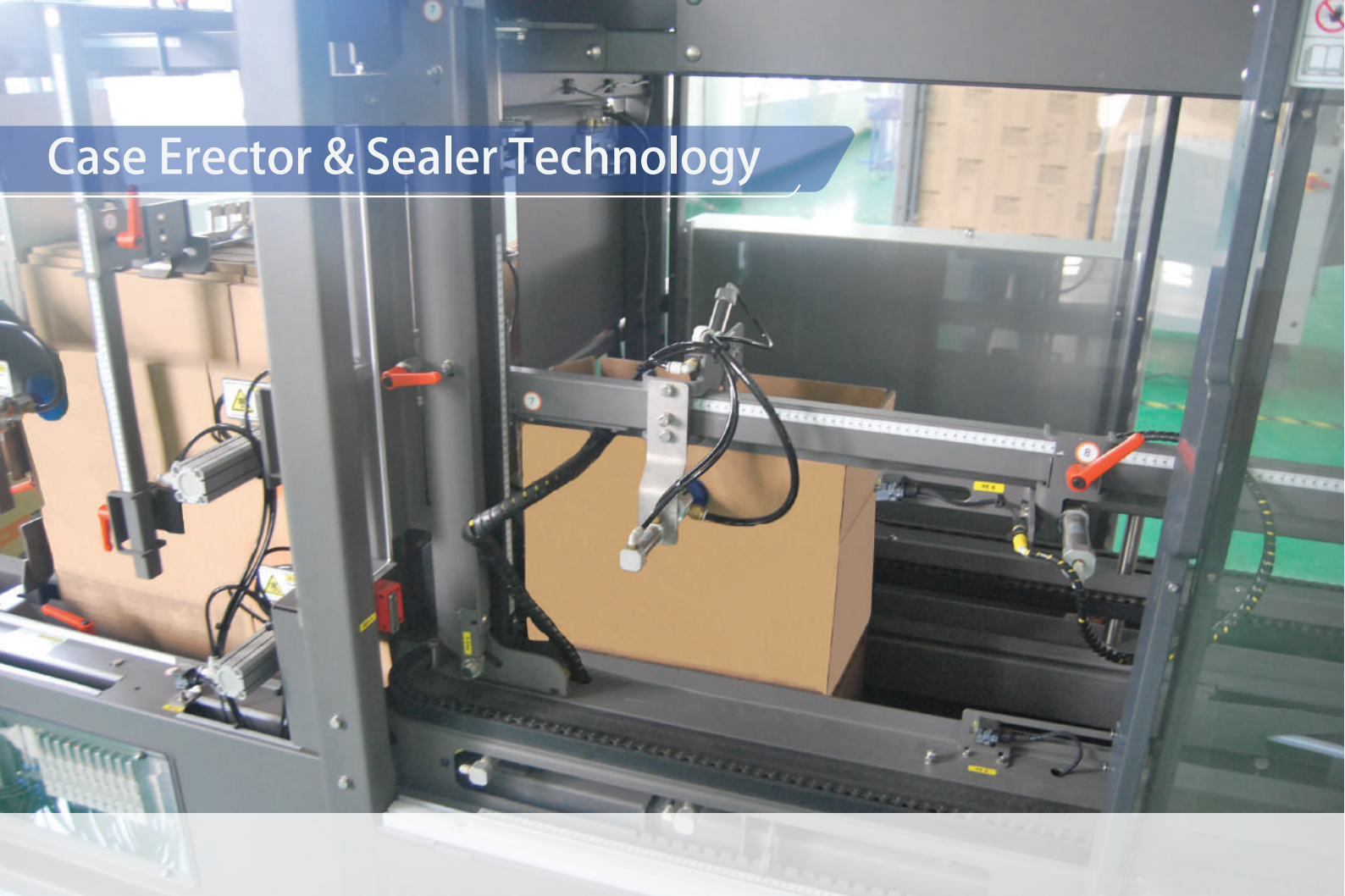

U-PACK YZ - CE & CS SERIES

Automatic Case Erector and Sealer Series



地址: 上海金山区田欢路558号

邮编: 201517

电话: +86 21 6979 2041

传真: +86 21 6979 2046

热线: **400 668 2041**

E-mail: sales@yuzhuang.com

网址: www.yuzhuang.com

视频: www.u-pack.tv

